



**DFG-50
GAS CONVECTION OVEN
REPLACEMENT PARTS LIST**



EFFECTIVE SEPTEMBER 12, 2002

THE BLODGETT CORPORATION

44 Lakeside Avenue, Burlington, Vermont 05401 USA
Telephone: (802) 860-3700 (800) 331-5842 Fax: (802) 860-3732
www.blodgett.com

Superseding All Previous Parts Lists.
The Company reserves the right to make substitution in the event that items specified are not available.
ERRORS: Descriptive and/or typographic errors are subject to correction.

www.blodgett.com

IMPORTANT: When ordering parts, please provide the model, gas type and serial number of the oven. The identification plate is located on the left side of the combustion compartment and, also, above the control panel under the ledge.

DFG-50

September 12, 2002

- ☑ ASAP Distributor Required Stocking Parts
- ◆ Doors Are Not Returnable

2

ELECTRICAL COMPONENTS

| <u>Ref. No.</u> | <u>Part No.</u> | <u>Descriptionx</u> |
|-----------------|-----------------|--|
| 1 | 20349 | Buzzer, for 115V Timer |
| 4 | 18868 | Mode Selector Switch w/o Knob |
| 5 | 16686 | Knob, Mode Selector Switch |
| | 30841 | Cool Down Switch, Rocker DPDT Red Replacement Kit (For 1 & 3 Set Point Only) |
| 2 | 18265 | Indicator Light, 28V, Red, Round |
| 3 | 20355 | Transformer, 115V to 24V |
| 6 | 32280 | Motor, 115V, 1 PH, 1/3 HP, 1 SP |
| 19 | 16994 | Blower Wheel Assy., (10-3/4" Diameter) |
| | 33147 | Wheel Puller |
| | 90034 | Lug, Grounding |
| | 5091 | Cord Set Assy. (6 Feet) |
| 8 | 20734 | Microswitch Assy., Door |
| | 21605 | Bracket, Door Microswitch |
| 7 | 20693 | Axial Fan, Low Velocity, 3" (Before 8/90) |
| 7 | 22301 | Axial Fan, 120V, 4-1/2" (After 8/90) |

MECHANICAL CONTROLS

FOR OVENS MANUFACTURED BEFORE 7/87

| <u>Ref. No.</u> | <u>Part No.</u> | <u>Description</u> |
|-----------------|-----------------|---|
| | 15956 | Timer, 60 Minute w/o Knob (Cook Only) |
| | 16030 | Knob, Timer |
| | 15673 | Indicator Light, 125V, Red, Round (Cook) |
| | 16536 | Thermostat, Cook KX-234-36 w/o Knob (140° - 500°) |
| | 17212 | Knob, Thermostat |
| | 16664 | Control Decal, Cook Only |

HOT SURFACE IGNITION

STANDARD ON OVENS MANUFACTURED BEFORE 3/86

| <u>Ref. No.</u> | <u>Part No.</u> | <u>Description</u> |
|-----------------|-----------------|--|
| | 20325 | Solenoid Valve/Pressure Regulator, Nat |
| | 20275 | Solenoid Valve/Pressure Regulator, LP |
| 13 | 17952 | Ignitor, Electric |
| 14 | 16529 | Thermal Delay Relay (Tube Only) |
| | 20661 | Base & Bracket, Thermal Delay Relay |
| | 16372 | Fuse, 5 AMP |
| | 20658 | Fuse Holder, 5 AMP Fuse |
| | 11200 | Terminal Block w/ Screws |

SPARK IGNITION SYSTEM

STANDARD ON OVENS MANUFACTURED AFTER 3/86

| <u>Ref. No.</u> | <u>Part No.</u> | <u>Description</u> |
|-----------------|-----------------|--|
| 9 | 30220 | Dual Solenoid/Pressure Regulator, Nat |
| | 30221 | Dual Solenoid/Pressure Regulator, LP |
| | 20348 | Spark Box, LP & Nat |
| | 34689 | Capacitor Assy, Snubber (After 1/21/99 or S.N. 012199SA044T) |
| 11 | 18584 | Pilot Burner, Complete, Nat |
| | 18585 | Pilot Burner, Complete, LP |
| 12 | 18256 | Flame Sensor Only |
| | 19677 | Wire, Flame Sensor |
| | 18263 | Orifice, Pilot, Nat |
| | 18257 | Orifice, Pilot, LP |
| | 21502 | Tube Assy., Pilot |
| | 20195 | Spark Gap Gauge (tool) |

SOLID STATE MANUAL CONTROLS

STANDARD ON OVENS MANUFACTURED AFTER 7/87

| <u>Ref. No.</u> | <u>Part No.</u> | <u>Description</u> |
|-----------------|-----------------|--|
| | 18430 | Temperature Controller, 3 Positions (Specify Model & Temperature Settings) |
| | 21604 | Temperature Controller, 1 Position (Specify Model & Temperature Settings) |
| | 17000 | Probe, Temperature (For 1 & 3 Position Controllers) |
| 16 | 18578 | Temperature Control Board |
| 17 | 18588 | Probe, Temperature |
| 20 | 18234 | Potentiometer, Remote (Infinite Control) |
| | 18577 | 8 Position Temperature Switch (Specify Model & Temperature Settings) |
| | 16686 | Knob, 8 Position Temperature Switch |
| 15 | 18225 | Timer, 60 Minute 120V |
| | 16686 | Knob, Timer |
| | 90099 | Heat Selector Switch, 3 Positions w/o Knob |
| | 16686 | Knob, Heat Selector Switch |
| | 19303 | Wiring Harness, Inf/8-3-1 STPT |
| | 17110 | Control Decal, Lexan (3 Position) |
| | 17109 | Control Decal, Lexan (1 Position) |
| | 19165 | Control Decal, Lexan (Infinite Cook Only) |
| | 19164 | Control Decal, Lexan (8 Set Point Cook) |

MISC. COMPONENTS

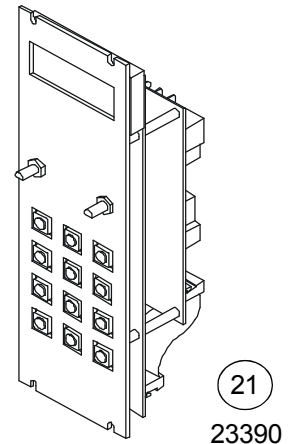
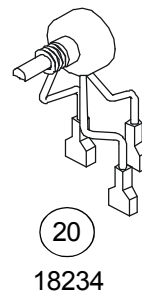
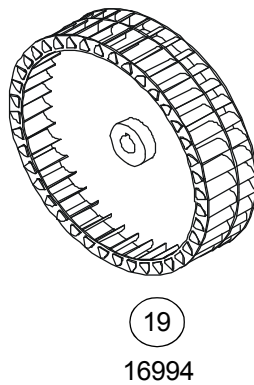
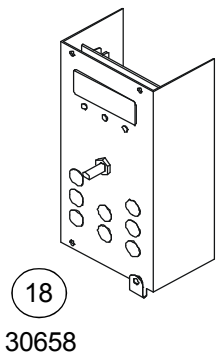
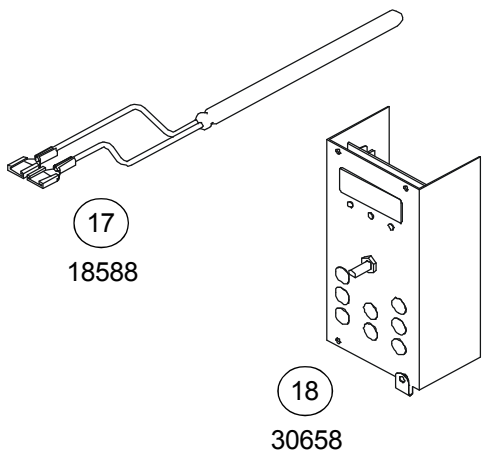
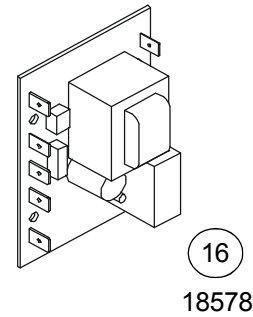
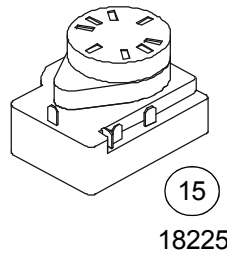
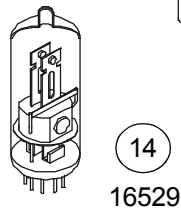
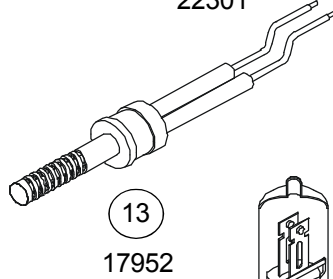
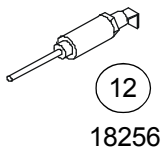
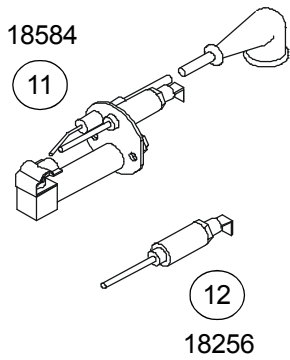
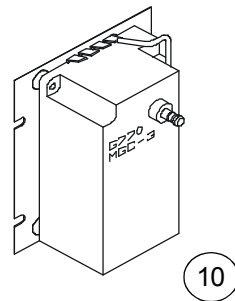
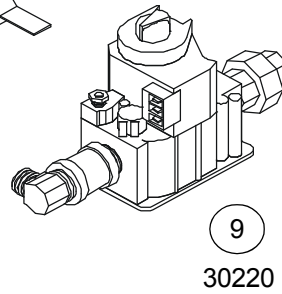
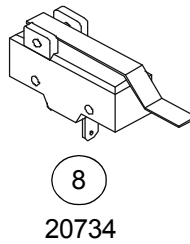
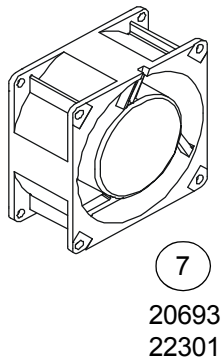
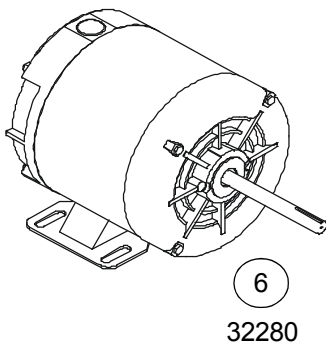
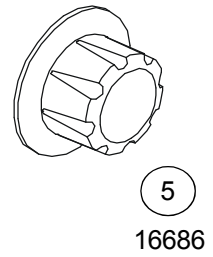
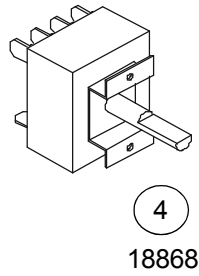
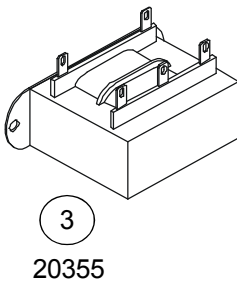
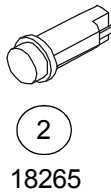
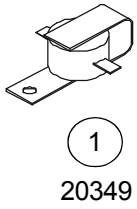

SOLID STATE DIGITAL CONTROLS

5 KEY

| <u>Ref. No.</u> | <u>Part No.</u> | <u>Description</u> |
|-----------------|-----------------|--|
| 18 | 30658 | Controller, Digital Time & Temp |
| | FW529 | Controller, Reconditioned |
| 17 | 18588 | Probe, Temperature |
| | 30662 | Momentary Light Switch |
| | 30663 | Control Panel & Decal Assy. |
| | 24684 | Knob, Mode Selector (for 30658) |
| | 24685 | Knob, Adjust |
| | 20348 | Spark Box LP & Nat |
| | 34689 | Capacitor Assy., Snubber (After 1/21/99 or S.N. 012199SA044T) |

INTELLITOUCH CONTROLS

17 KEY

| <u>Ref. No.</u> | <u>Part No.</u> | <u>Description</u> |
|-----------------|-----------------|--|
| | 20780 | Temperature Controller, Integrated (Specify Model & Temperature Settings) |
| | 20360 | Probe, Temperature Integrated |
| | 18960 | Board, Interface KFC |
| | 20112 | RFI Filter (Used w/ Integrated Controller) |
| | 19341 | Relay, SPDT, 24V |
| | 19525 | Metal Oxide Varistor Assy. |
| | 19393 | Control Panel & Decal Assy. |
| | 19627 | Spacer, Brass (Qty 6) |
| | 18934 | Spacer, Aluminum (Qty 6) |

INTELLIHOLD CONTROLS

12 KEY

| <u>Ref. No.</u> | <u>Part No.</u> | <u>Description</u> |
|-----------------|-----------------|--|
| 21 | 23390 | Controller, Intellihold (12 Key) |
| | 23392 | Probe, Temperature |
| | 21443 | Knob, Control |
| | 19620 | Switch, Rocker, DPST, Black |
| | 19341 | Relay, SPDT, 24V |
| | 20678 | Wiring Harness, Control Panel |
| | 19306 | Wiring Harness |
| | 22519 | Control Panel & Decal Assy., Intellihold |

BURNER & PIPING COMPONENTS

| <u>Ref. No.</u> | <u>Part No.</u> | <u>Description</u> |
|-----------------|-----------------|---|
| | 19967 | Burner Assy., (Before 3/86) |
| | 19968 | Burner Assy., (After 3/86) |
| | 17066 | Deflector Assy, |
| | 19409 | Orifice, Main Burner (Specify Model & Gas Type) |
| | 4013 | Air Shutter Only |
| | 3001 | Locknut, Air Shutter |
| | 17103 | Nipple, Manifold 1/2" x 7-1/4" (Before 3/86) |
| | 10762 | Coupling, Reducer 1/2" x 3/4" |
| | 3807 | Union, 1/2" Female |
| | 1949 | Nipple, 1/2" x Close |
| | 597 | Ell, 90° Black |
| | 17102 | Ell, 45° Black |
| | 10252 | Union, Ell 1/2" |
| | 21545 | Manifold Tube Assy., (After 3/86) |
| | 21547 | Ignitor Shield (After 3/86) |
| | 21548 | Bracket, Manifold (After 3/86) |
| | 10651 | Valve, Manual Gas Shut-Off (Before 3/86) |
| | 10809 | Control Stack Nipple 1/2" x 2" |
| | 11508 | Control Stack Nipple 1/2" x 4" |

FAN DELAY WITH PULSE PLUS

| <u>Ref. No.</u> | <u>Part No.</u> | <u>Description</u> |
|-----------------|-----------------|---|
| | 18290 | Timer, 10 Minute, 115V |
| | 18292 | Timer, 30 Minute, 120V |
| | 21051 | Timer, Solid State, Pulsing, 30 Second, 120V |
| | 15709 | Indicator Light, 125V, Amber, Round |
| | 15673 | Indicator Light, 125V, Red, Round |
| | 18587 | Relay, 3PDT, 120V w/ Bracket |
| | 19304 | Wiring Harness, Fan Delay, Solid State (Infinite & 8 Set Point) |
| | 19166 | Control Panel & Decal, Lexan (8 Set Point) |
| | 19167 | Control Panel & Decal, Lexan (Infinite) |

COMPUTER READY OVENS

| <u>Ref. No.</u> | <u>Part No.</u> | <u>Description</u> |
|-----------------|-----------------|--|
| | 20080 | Probe, Temperature (Dual 4 Wire) for 1 & 3 Position Boards |
| | 16645 | Probe, Temperature (2 Wires) for 8 Set Point and Infinite Boards |
| | 17925 | Cable Extension (For Sgl Oven) |
| | 18273 | Wire Assy., Extension (For Dbl Oven) |

COOK & HOLD CONTROLS

| <u>Ref. No.</u> | <u>Part No.</u> | <u>Description</u> |
|-----------------|-----------------|---|
| | 17986 | Timer, 12 Hour w/ Knob (Before 7/87) |
| | 17864 | Timer, 12 Hour w/o Knob (After 7/87) |
| | 16686 | Knob, Timer |
| | 15365 | Thermostat, Hold KX-274-36 (Before 7/87) |
| | 16392 | Knob, Hold Thermostat |
| | 20351 | Temperature Controller, Hold (150° - 250°) (After 7/87) |
| | 16686 | Knob, Hold Temperature Controller |
| | 20347 | Mode Selector Switch w/o Knob |
| | 16686 | Knob, Mode Selector Switch |
| | 15709 | Indicator Light, 125V, Amber, Round (Hold) |
| | 90043 | Relay, Motor, DPDT |
| | 16998 | Relay, 120V, SPST, 30 AMP (Before 7/87) |
| | 18587 | Relay, 120V, 3PDT, 30 AMP (After 7/87) |
| | 90029 | Terminal Block w/ Screws |
| | 21438 | Base & Bracket, TDR (Before 7/87) |
| | 19163 | Control Decal, Lexan (After 7/87) |

BAKING COMPARTMENT COMPONENTS

| <u>Ref. No.</u> | <u>Part No.</u> | <u>Description</u> |
|-----------------|-----------------|--|
| | 22637 | Rack, w/ball stops, Each (20-7/8" x 14-5/8") |
| | 8590 | Rack Support (Set of 2) (Before 8/91) |
| | 31311 | Rack Support (Set of 2) (After 8/91) |
| 19 | 16994 | Blower Wheel Assy. |
| | 17333 | Thermostat Bulb Clip (Each) |
| | 35934 | Interior Baffle & Bracket Kit |
| | | Blower Wheel Cover, Porc. Replaces 16990 |
| | 16987 | Interior Baffle, Blower Wheel Cover) S/S |

EXTERIOR OVEN COMPONENTS

| <u>Ref. No.</u> | <u>Part No.</u> | <u>Description</u> |
|-----------------|-----------------|---|
| | 6433 | Crown Assy. |
| | 16476 | Logo/Instruction Decal |
| | 90086 | Nameplate, Blodgett |
| | 17032 | Combustion Compartment Cover, LH Hinge |
| | 30996 | Combustion Compartment Cover, RH Hinge |
| | 21600 | Access Panel, S/S (Removeable Bodyside) (Units before 7/1/98) |
| | 34878 | Access Panel, S/S (Removeable Bodyside) (Units after 7/1/98) |
| | 30990 | Draft Diverter, Canopy Vent, S/S |
| | 30989 | Drafthood, Direct Vent (6" Dia.) S/S |

DOOR COMPONENTS

| <u>Ref. No.</u> | <u>Part No.</u> | <u>Description</u> |
|---|-----------------|---|
| <u>MANUFACTURED AFTER 9/84</u> | | |
| ◆ | 18404 | Door Assy, Gls, LH Hinge |
| ◆ | 18405 | Door Assy, Sld, LH Hinge |
| ◆ | 19609 | Door Assy, Gls, RH Hinge |
| ◆ | 19610 | Door Assy, Sld, RH Hinge |
| <u>MANUFACTURED BEFORE 9/84</u> | | |
| ◆ | 17805 | Door Assy, Roller Latch Conv. Glass |
| ◆ | 17806 | Door Assy, Roller Latch Conv. Solid |
| NOTE: Door assemblies do not include part # 17865 (Roller latch). Please order this part separately. | | |
| | 9036 | Window Assy, Door (17-1/8" x 10-1/8") |
| | 17865 | Latch, Roller w/ Screws (on Oven) (Manufactured after 9/84) |
| | 17946 | Catch, Door Roller Assy w/ Screws (on door) (Manufactured after 9/84) |
| | 90087 | Door Catch, Spring Clip (Manufactured before 9/84) |
| | 8589 | Door Handle, 13" |
| | 17862 | Perimeter Gasket, Door (Manufactured after 9/84) |
| | 17336 | Perimeter Gasket, Door (Manufactured before 9/84) |
| | 17337 | Lower Hinge Pin w/ Fasteners, Door |
| | 8594 | Upper Hinge Pin, Door |
| | 90017 | Washers, Door (Set of 2) |
| | 90004 | Bushings, Upper Door Hinge (Set of 2) |
| | 8633 | Cam Assy., Door Switch |

STANDS

| <u>Ref. No.</u> | <u>Part No.</u> | <u>Description</u> |
|-----------------|-----------------|-----------------------------------|
| | 11993 | Stand, 5-3/4" S/S |
| | 10857 | Stand, 7" S/S |
| | 18479 | Stand, 16" S/S w/ Shelf |
| | 10856 | Stand, 19" S/S w/ Shelf |
| | 10855 | Stand, 24" S/S w/ Shelf |
| | 10854 | Stand, 33" S/S w/ Shelf |
| | 18482 | Stand, 16" S/S w/ Shelf & Casters |
| | 11437 | Stand, 19" S/S w/ Shelf & Casters |
| | 15151 | Stand, 24" S/S w/ Shelf & Casters |
| | 15153 | Stand, 33" S/S w/ Shelf & Casters |
| | 20609 | Shelf for Stand, Ptd |
| | 20497 | Shelf for Stand, S/S |
| | 16002 | Castors (Set of 4) |
| | 20435 | Legs, 4" w/ Bolts, Ptd (Set of 4) |

EXCLUSIVE TO EXPORT

EXCLUSIVE TO EXPORT - KFC JAPAN

| <u>Ref. No.</u> | <u>Part No.</u> | <u>Description</u> |
|-----------------|-----------------|--|
| | 20356 | Transformer, 230V to 240V |
| | 21430 | Axial Fan, 230V (Before 8/13/90) |
| | 22302 | Axial Fan, 240V (After 8/13/90) |
| | 20084 | Timer, 60 Minute, 240V |
| | 20427 | Timer, 12 Hour, 240V |
| | 18582 | Relay, 3PDT, 240V |
| | 19666 | Relay, DPDT |
| | 16539 | Indicator Light, 250V, Amber, Round |
| | 34530 | Pilot Burner & Ignitor Assy, Nat CE |
| | 34531 | Pilot Burner & Ignitor Assy, LP/But CE |
| | 20084 | Timer, 60 Minute, 240V |
| | 20427 | Timer, 12 Hour, 240V |
| | 19982 | Thermostat, High Limit |
| | 18783 | Transformer, 230V to 24V |
| | 22302 | Axial Fan, 240V |
| | 18786 | Fuse |
| | 22989 | Fuseblock |
| | 18551 | Resistor, 1 Meg |
| | 20298 | Wire, Green 30" |
| | 20299 | Wire, Green 32" |
| | 20305 | Wire, Green 18" |
| | 18782 | Dual Solenoid/Pressure Regulator, Nat |
| | 19672 | Wire Assy., White, 27" |
| | 32280 | Motor, 115/230V, 1 SP, 1/3 HP |
| | 22988 | Control Panel & Decal Assy. |
| | 33202 | Tube, Pilot |
| | 33205 | Stack Assy, Control CE |
| | 33298 | Fuse, 250V, 50MA CE |
| | 33282 | Fuseholder, In-Line |
| | 33360 | Manifold Assy, CE |
| | M3168 | Ignition Control, Landis & Gyr |
| | M6449 | Filter, Noise |
| | M3172 | Timer, Fixed 2 Second |
| | 36066 | Thermostat, High Limit Kit (Manual Reset) CE Replaces M3295 |
| | 34781 | Conversion Kit, Air Pressure Differential Switch (Replaces M3330) CE (Before 3/23/99 or S.N. 032399SA066S) |
| | M9422 | Air Pressure Differential Switch, switch only CE |
| | M9705 | Polyurethane Tubing, used w/pressure switch (Per Foot, Total 3 FT) CE |
| | 30658 | Solid State Digital Controller |
| | 18588 | Probe, Temperature |
| | 16539 | Light, Indicator 250V, Amber, Round |
| | 30517 | Switch, Rocker DPST, Black |
| | 18578 | Temperature Control Board (Solid State Manual) |
| | 18588 | Probe, Temperature (Solid State Manual) |
| | 18234 | Potentiometer, Remote (Infinite Control) |
| | 16037 | Light, Indicator 250V, Red, Round |
| | 33360 | Manifold Assy. CE |
| | 20348 | Spark Box CE |

| <u>Ref. No.</u> | <u>Part No.</u> | <u>Description</u> |
|-----------------|-----------------|---|
| | 22990 | Transformer, 100V to 24V |
| | 22991 | Interface Board |
| | 22993 | Mounting Plate, Interface Board |
| | 20248 | Interface Harness |
| | 20179 | Blower Wheel |
| | 20253 | Spacer, Steel |
| | 18877 | Spacer, Brass |
| | 32325 | Motor, 115V, 1 PH, 1/3 HP |
| | 22992 | Control Panel & Decal Assy. |
| | 30842 | Cool Down Switch, Rocker DPDT Red Replacement Kit (For 1 Set Point Only) |